

# GRAND BALLROOM



## Grand Ballroom

The name says it all. This magnificent pillar-less ballroom has the ability to transform right before your eyes, from formal banquets to large cocktail receptions and conferences to exhibitions.

Featuring a stunning glass panelled pre-function area offering sweeping views of the Perth skyline, the Grand Ballroom can seat up to 1,200 guests banquet style or divide into two separate venues for smaller events.

This venue is one of only a few in Australia to have a six metre high ceiling with a mounted catwalk, designed to allow for special lighting to make your event stand out from the rest.

## Special Features

- Pre-function areas with views of Burswood Park, Swan River and Perth Skyline
- Expansive pre-function area ideal for receptions or exhibitions
- Dedicated registration area with ample storage
- Rear loading truck and vehicle access
- Option to have pin spot lighting

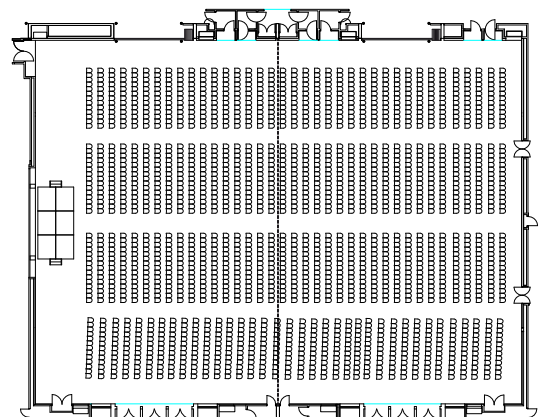
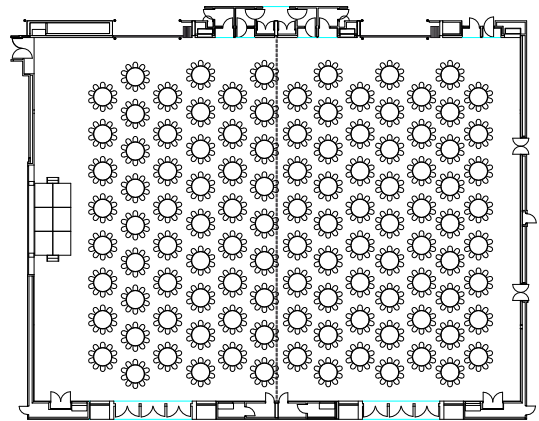

# GRAND BALLROOM



## Venue Capacity

VENUE	Area (m <sup>2</sup> )	Height	Banquet	Booths	Classroom	Cocktails	Theatre	U-Shape
Grand Ballroom	1850.00	6.00	1100	130	900	1800	1800	N/A
Grand Ballroom One	925.00	6.00	550	65	450	900	900	N/A
Grand Ballroom Two	925.00	6.00	550	65	450	900	900	N/A
Grand Ballroom Foyer	1500.00	7.00	N/A	60	N/A	1000	N/A	N/A